

THESE DRAWINGS AND SPECIFICATIONS ARE THE PROPERTY OF JBL, INCORPORATED. THEY ARE ISSUED IN STRICT CONFIDENCE AND SHALL NOT BE REPRODUCED OR USED AS THE BASIS FOR MANUFACTURE OR APPARATUS WITHOUT WRITTEN PERMISSION.

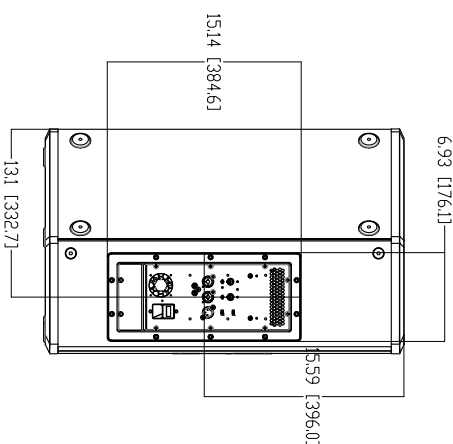

- NOTES: UNLESS OTHERWISE SPECIFIED
1. COMPONENTS: LF 1X 275G HF 1X 2408H-2
  2. INPUT 2X XLR WITH LOOP-THRU
  3. GRILLE: 16 GA PERFORATED CR3 POWDER COATED BLACK WITH CLOTH BACKING.
  4. MATERIALS: 18mm BIRCH FACED POPULAR.
  5. FINISH: BLACK DUREPLEX.
  6. SUSPENSION POINTS: 12X M10 THREADED SUSPENSION POINTS.
  7. POLE MOUNT: DIA. 35mm (1-3/8") FEMALE SOCKET WITH 0 AND 15 DEGREE RAILING ANGLES.
  8. WEIGHT: 44.1BS (20 kg).
  9. INDICATES CENTER OF GRAVITY.

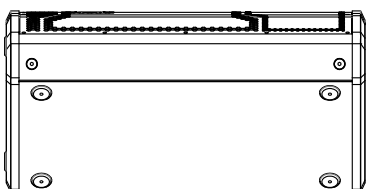
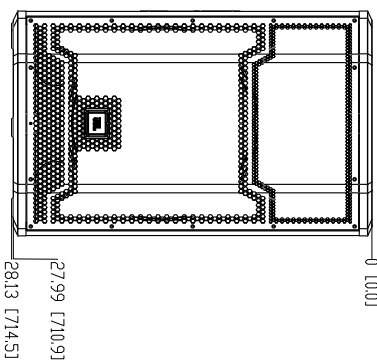
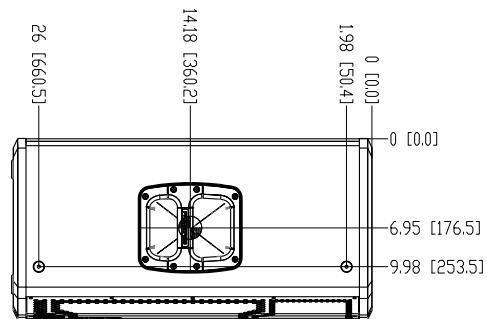
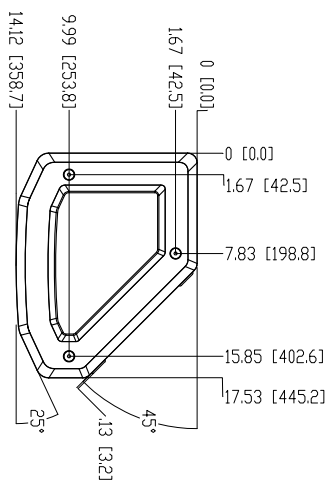
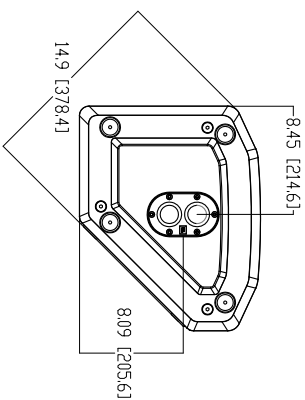

REV	DESCRIPTION	DATE
1.0	RELEASE TO MARKETING	3/27/2014

TOLERANCES UNLESS OTHERWISE SPECIFIED		JBL PROFESSIONAL A Harman International Company Northridge, California 91329 U.S.A.	
XX ± .063 INCH		CUSTOMER DRAWING, PRX715	
XX ± .125 INCH			
ANGULAR TOLERANCE OF 0°-23°			
FRACTIONAL DIMENSIONS ± 1/32			
ALL DIMENSIONS ARE FINISHED DIMENSIONS		TITLE	
DO NOT SCALE DRAWING		SCALE NTS	
SIZE		DRAWING NO.	
A		1000135400	
SHEET 1		OF 1	
REV		A	